

# Fastener Tightening Specifications

Application	Specification	
	Metric	English
Center Bearing-to-Vehicle Underbody Bolts	25 N·m	19 lb ft
Propeller Shaft-to-Rear Differential Flange Bolts	50 N·m	37 lb ft
Propeller Shaft-to-Transfer Case Flange Bolts	35 N·m	25 lb ft

# Adhesives, Fluids, Lubricants, and Sealers

Application	Type of Material	GM Part Number	
		United States	Canada
Center Bearing Mounting Bolts, Front Propeller Shaft Mounting Bolts to the Transfer Case Flange, Rear Propeller Shaft Mounting Bolts to the Differential Yoke.	Threadlocker	89021297	10953488



# Propeller Shaft Replacement

## Removal Procedure

**Note:** Before removing the propeller shaft from the vehicle, paint or scribe reference marks on the transfer case flange to the propeller shaft flange and the rear differential drive flange to ensure minimal driveline system imbalance.

1. Raise and support the vehicle. Refer to [Lifting and Jacking the Vehicle](#).

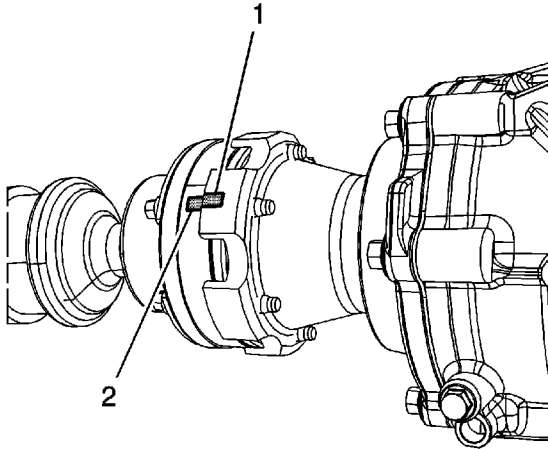

2. Mark the relationship of the front propeller shaft (2) to the transfer case drive flange (1).

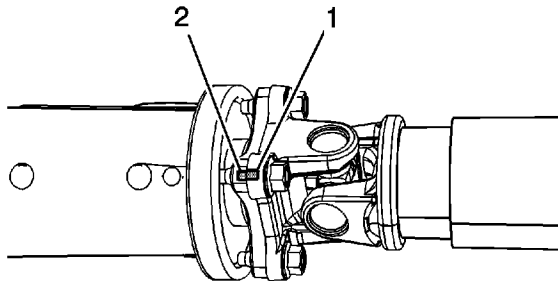

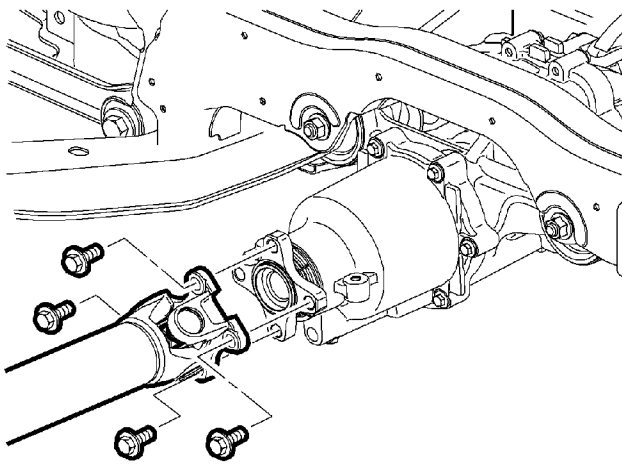

4. Remove the mounting bolts and the propeller shaft bolts from the rear differential drive flange.
5. Support the propeller shaft at the rear differential.

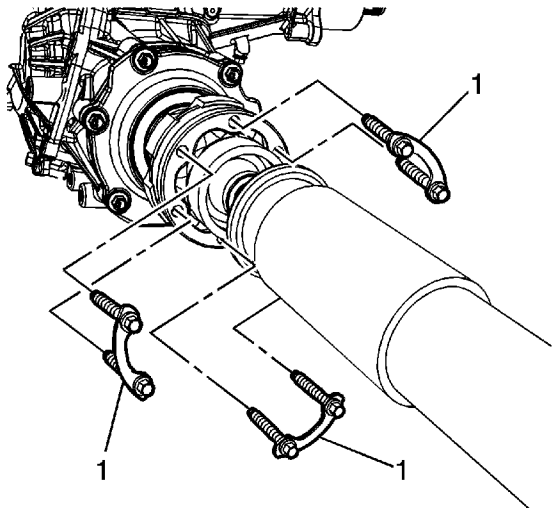

6. Remove the propeller shaft bolts and washers (1).

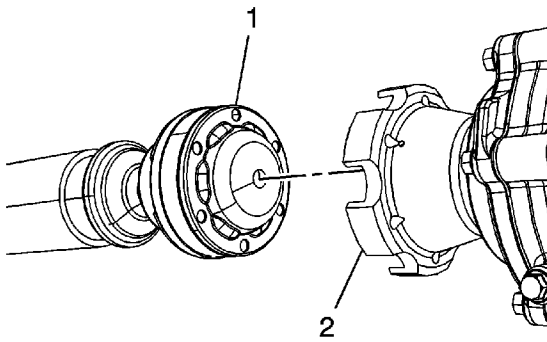

**Note:** If the propeller drive shaft cannot be removed, proceed to step 8. Failure to do so will damage the propeller shaft.

7. Remove the propeller shaft (1) from the transfer case flange (2).

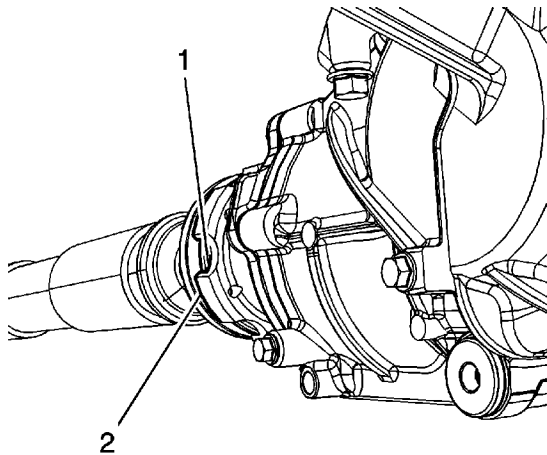

8. Place a brass drift or punch on the propeller shaft (1) between one of the notches in the transfer case drive flange (2).
9. Using a hammer and the brass drift or punch, remove the propeller drive shaft from the transfer case drive flange (2).
10. Remove the propeller shaft (1) from the rear differential drive flange (2).
11. Support the propeller shaft at the transfer case drive flange.

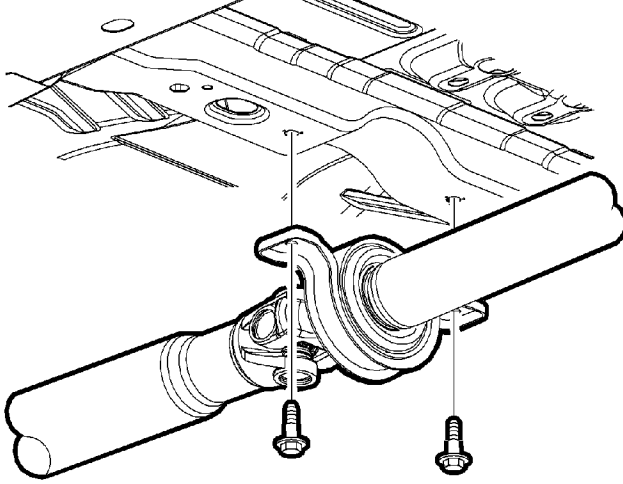

12. Remove the center support mounting bolts.
13. With the aid of an assistant, remove the propeller shaft from the supports and the vehicle.

## Installation Procedure

**Note:** Align the paint or scribe reference marks on the transfer case flange to the propeller shaft flange and the rear differential drive flange to ensure minimal driveline system imbalance.

1. Clean the mounting bolts for the center bearing, front and rear propeller shaft drive flanges. Refer to [Adhesives, Fluids, Lubricants, and Sealers](#).
2. With the aid of an assistant, position the propeller shaft on the supports.

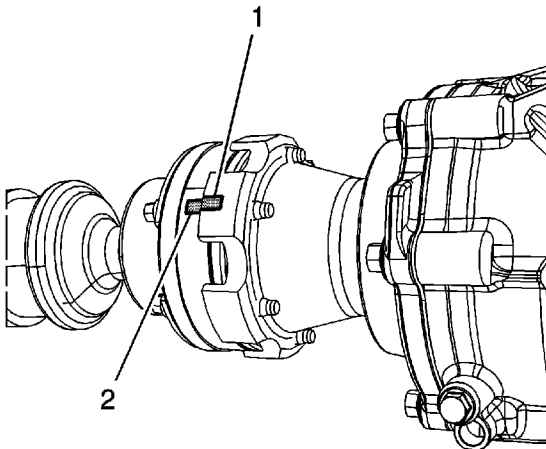

3. Align the reference marks on the front propeller shaft (2) to transfer case flange (1).

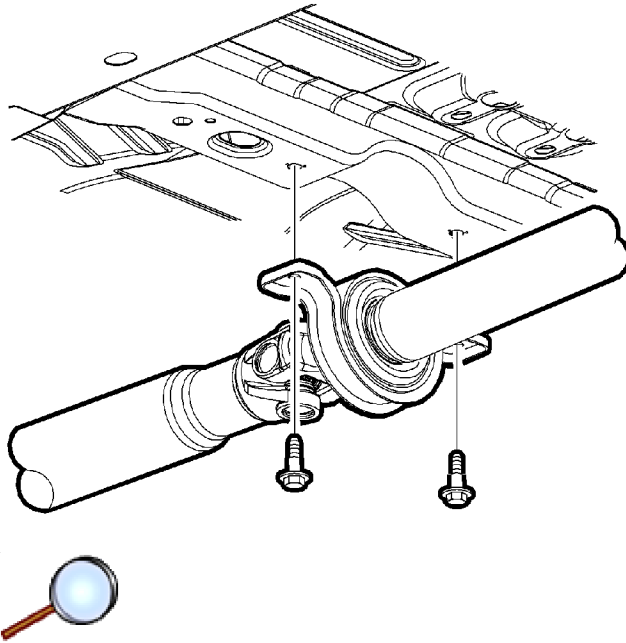

**Note:** Install the mounting bolt to hold the center bearing in place.

4. Position the center support bearing on the vehicle.

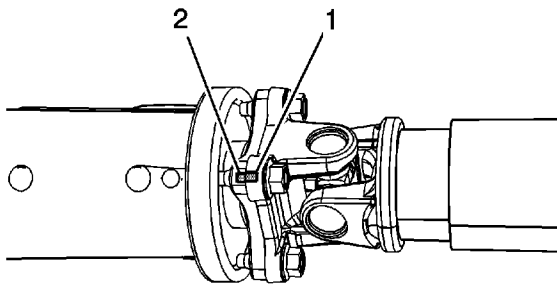

**Note:** Install a few of the mounting bolts to hold the propeller shaft in place.

5. Align the reference marks on the rear propeller shaft (1) to the rear differential yoke (2).

**Caution:** Refer to [Fastener Caution](#) in the Preface section.

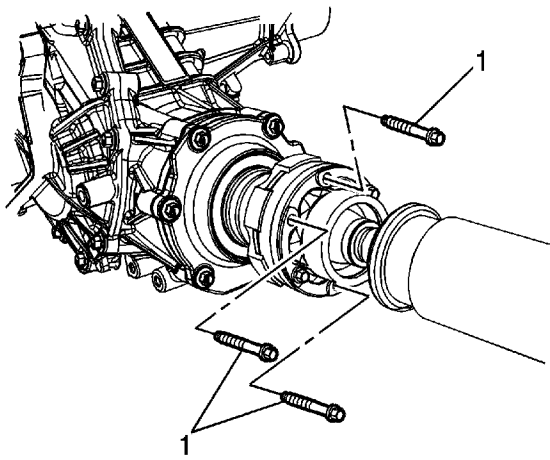

6. Install the remaining bolts and washers (1) from the propeller shaft to the transfer case flange and tighten to **35 N·m (25 lb ft)**.
7. Tighten the center bearing mounting bolts to **25 N·m (19 lb ft)**.

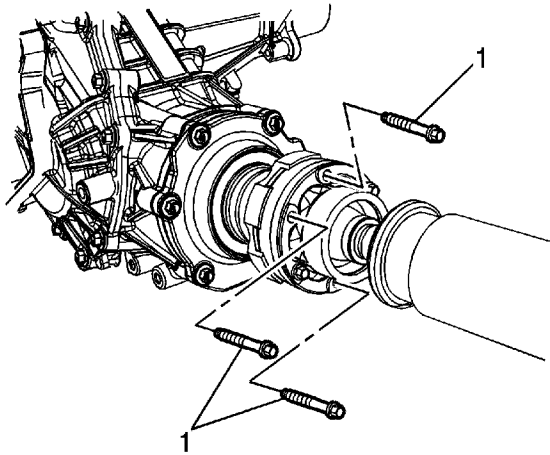

8. Install the remaining mounting bolts (1) from the propeller shaft to the rear differential yoke and tighten to **50 N·m (37 lb ft)**.
9. Remove the supports from the vehicle.
10. Lower the vehicle.